

design that  
makes life easier



# Panasonic

X-tendia



X-tendia with its special holder bracket will be the common solution for safe and comfortable usage in office, site, workshop or home.

X-tendia

hang it or fix it...  
X-tendia suits  
everywhere



- Can be fixable on
- Can be hanged when required
- Child protection feature in all products
- Special rear cover in cordless and switched products for safer cable assembly
- Illuminated on/off push-button as an option
- 2-gang, 3-gang, 4-gang, 5-gang and 6-gang product options
- Cordless or 1.5 m, 2 m, 3 m and 5 m cable options
- Black and white product color options



**X-tendia makes the life easier with its holder bracket in all places that it will be used.**



## Hanging with Holder Bracket

It's very easy to use X-tendia when you need to hang it. Guide pin on the holder bracket is easily inserted into its suitable housing on X-tendia and it becomes ready to be used for hanging.

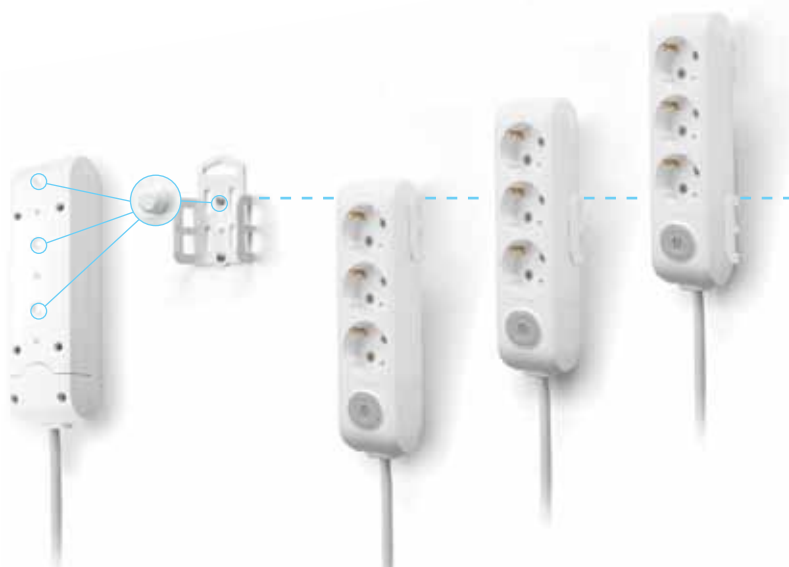
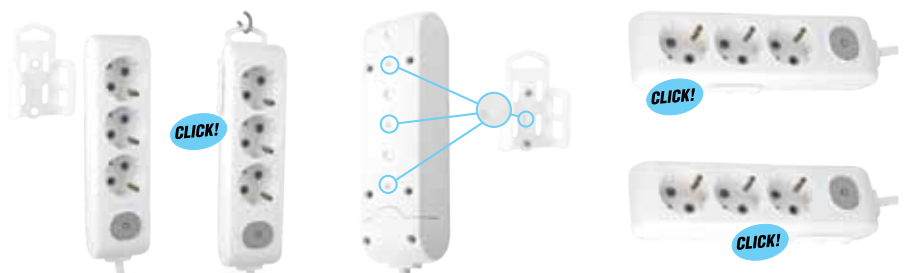

## Fixing on Flat Surfaces

X-tendia offers different alternatives for fixing on flat surfaces. Holder bracket can be easily fixed on the desired surface with suitable screws through screw holes. Then guide pin on the holder bracket can be easily inserted into the desired housing on X-tendia and it becomes ready for fixing.

X-tendia

smart design,  
safe usage

### More Comfort with Illuminated on/off Push Button

You can switch on or switch off all connected devices without removing the plugs, thanks to the illuminated on-off push-button.



### Long-lasting Structure

X-tendia's structure designed for safe usage in office, home, workshop and site.

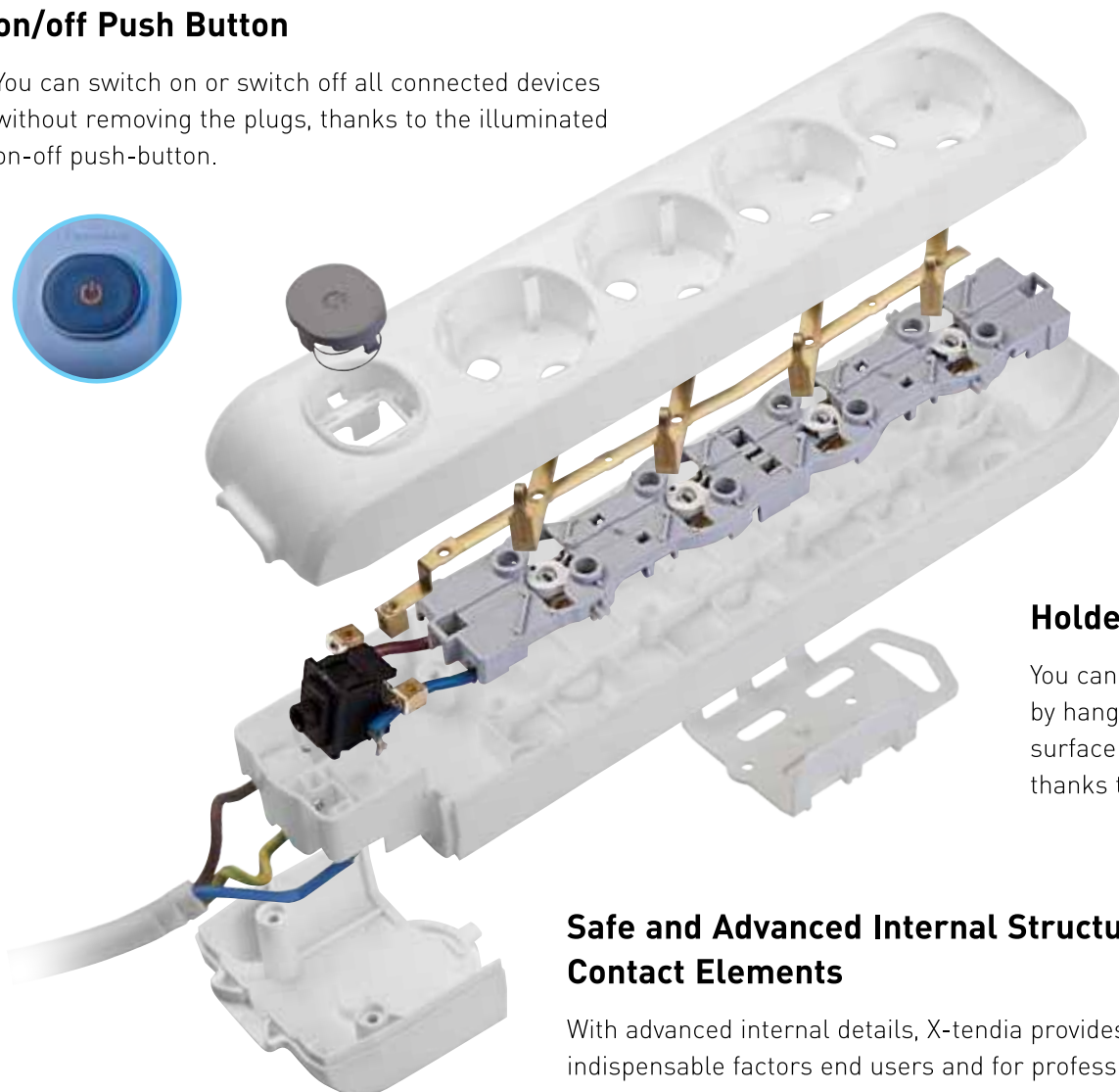

### Holder Bracket

You can use X-tendia either by hanging or fixing on a flat surface wherever you wish thanks to its holder bracket.

### Safe and Advanced Internal Structure and Contact Elements

With advanced internal details, X-tendia provides indispensable factors end users and for professionals.

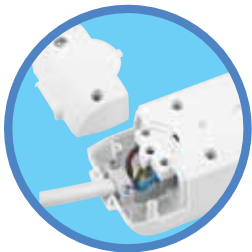

## Special Rear Cover for Safe Assembly

Everything is for safe cable assembly. For cordless products and products with switches, cable assemblies are performed safely only by opening the special rear cover on the backside of X-tendia.



## Child Protection Feature in all Products

For increased safety child protection feature is offered as a standard feature in X-tendia.

## Safe and Reliable Usage

X-tendia features a special contact design for safe and reliable operation.



## Group Sockets with Earthing

**WLTB0420-2** □ □

2x Socket 2P+E, Child Prot.  
w/o Cord  
Color ○ ●



**WLTB0430-2** □ □

3x Socket 2P+E, Child Prot.  
w/o Cord  
Color ○ ●



**WLTB0440-2** □ □

4x Socket 2P+E, Child Prot.  
w/o Cord  
Color ○ ●



**WLTB0450-2** □ □

5x Socket 2P+E, Child Prot.  
w/o Cord  
Color ○ ●



**WLTB0421-2** □ □

2x Socket 2P+E, Child Prot.  
1,5m Cord  
Color ○ ●



**WLTB0431-2** □ □

3x Socket 2P+E, Child Prot.  
1,5m Cord  
Color ○ ●



**WLTB0441-2** □ □

4x Socket 2P+E, Child Prot.  
1,5m Cord  
Color ○ ●



**WLTB0451-2** □ □

5x Socket 2P+E, Child Prot.  
1,5m Cord  
Color ○ ●



**WLTB0422-2** □ □

2x Socket 2P+E, Child Prot.  
2m Cord  
Color ○ ●



**WLTB0432-2** □ □

3x Socket 2P+E, Child Prot.  
2m Cord  
Color ○ ●



**WLTB0442-2** □ □

4x Socket 2P+E, Child Prot.  
2m Cord  
Color ○ ●



**WLTB0452-2** □ □

5x Socket 2P+E, Child Prot.  
2m Cord  
Color ○ ●



**WLTB0423-2** □ □

2x Socket 2P+E, Child Prot.  
3m Cord  
Color ○ ●



**WLTB0433-2** □ □

3x Socket 2P+E, Child Prot.  
3m Cord  
Color ○ ●



**WLTB0443-2** □ □

4x Socket 2P+E, Child Prot.  
3m Cord  
Color ○ ●



**WLTB0453-2** □ □

5x Socket 2P, Child Prot.  
3m Cord  
Color ○ ●



**WLTB0425-2** □ □

2x Socket 2P+E, Child Prot.  
5m Cord  
Color ○ ●



**WLTB0435-2** □ □

3x Socket 2P+E, Child Prot.  
5m Cord  
Color ○ ●



**WLTB0445-2** □ □

4x Socket 2P, Child Prot.  
5m Cord  
Color ○ ●



**WLTB0455-2** □ □

5x Socket 2P, Child Prot.  
5m Cord  
Color ○ ●



**Group Sockets with Earthing**

**WLTB0460-2** □□  
 6x Socket 2P+E, Child Prot.  
 w/o Cord  
 Color ○ ●



**WLTB0461-2** □□  
 6x Socket 2P+E, Child Prot.  
 1,5m Cord  
 Color ○ ●



**WLTB0462-2** □□  
 6x Socket 2P+E, Child Prot.  
 2m Cord  
 Color ○ ●



**WLTB0463-2** □□  
 6x Socket 2P+E, Child Prot.  
 3m Cord  
 Color ○ ●



**WLTB0465-2** □□  
 6x Socket 2P+E, Child Prot.  
 5m Cord  
 Color ○ ●



**Group Sockets with Earthing and Switch**

**WLTA0420-2** □□  
 2x Socket 2P+E, Child Prot.  
 Switch w/o Cord  
 Color ○ ●



**WLTA0421-2** □□  
 2x Socket 2P+E, Child Prot.  
 Switch 1,5m Cord  
 Color ○ ●



**WLTA0422-2** □□  
 2x Socket 2P+E, Child Prot.  
 Switch 2m Cord  
 Color ○ ●



**WLTA0423-2** □□  
 2x Socket 2P+E, Child Prot.  
 Switch 3m Cord  
 Color ○ ●



**WLTA0425-2** □□  
 2x Socket 2P+E, Child Prot.  
 Switch 5m Cord  
 Color ○ ●



**WLTA0430-2** □□  
 3x Socket 2P+E, Child Prot.  
 Switch w/o Cord  
 Color ○ ●



**WLTA0431-2** □□  
 3x Socket 2P+E, Child Prot.  
 Switch 1,5m Cord  
 Color ○ ●



**WLTA0432-2** □□  
 3x Socket 2P+E, Child Prot.  
 Switch 2m Cord  
 Color ○ ●



**WLTA0433-2** □□  
 3x Socket 2P+E, Child Prot.  
 Switch 3m Cord  
 Color ○ ●



**WLTA0435-2** □□  
 3x Socket 2P+E, Child Prot.  
 Switch 5m Cord  
 Color ○ ●



**WLTA0440-2** □□  
 4x Socket 2P+E, Child Prot.  
 Switch w/o Cord  
 Color ○ ●



**WLTA0441-2** □□  
 4x Socket 2P+E, Child Prot.  
 Switch 1,5m Cord  
 Color ○ ●



**WLTA0442-2** □□  
 4x Socket 2P+E, Child Prot.  
 Switch 2m Cord  
 Color ○ ●



**WLTA0443-2** □□  
 4x Socket 2P+E, Child Prot.  
 Switch 3m Cord  
 Color ○ ●



**WLTA0445-2** □□  
 4x Socket 2P+E, Child Prot.  
 Switch 5m Cord  
 Color ○ ●



**Variety of Colors**

White Black



The last 2 characters in □□ of product numbers show the item color.

- White — WH
- Black — BL

## Group Sockets with Earthing and Switch

**WLTA0450-2** □□

5x Socket 2P+E, Child Prot.  
Switch w/o Cord  
Color ○ ●



**WLTA0460-2** □□

6x Socket 2P+E, Child Prot.  
Switch  
Color ○ ●



**WLTB0630-2** □□

3x Socket 2P+E, Child Prot.  
w/o Cord  
Color ○ ●



**WLTB0640-2** □□

4x Socket 2P+E, Child Prot.  
w/o Cord  
Color ○ ●



**WLTA0451-2** □□

5x Socket 2P+E, Child Prot.  
Switch 1,5 m Cord  
Color ○ ●



**WLTA0461-2** □□

6x Socket 2P+E, Child Prot.  
Switch 1,5m Cord  
Color ○ ●



**WLTB0631-2** □□

3x Socket 2P+E, Child Prot.  
1,5m Cord  
Color ○ ●



**WLTB0641-2** □□

4x Socket 2P+E, Child Prot.  
1,5m Cord  
Color ○ ●



**WLTA0452-2** □□

5x Socket 2P+E, Child Prot.  
Switch 2m Cord  
Color ○ ●



**WLTA0462-2** □□

6x Socket 2P+E, Child Prot.  
Switch 2m Cord  
Color ○ ●



**WLTB0632-2** □□

3x Socket 2P+E, Child Prot.  
2m Cord  
Color ○ ●



**WLTB0642-2** □□

4x Socket 2P+E, Child Prot.  
2m Cord  
Color ○ ●



**WLTA0453-2** □□

5x Socket 2P+E, Child Prot.  
Switch 3m Cord  
Color ○ ●



**WLTA0463-2** □□

6x Socket 2P+E, Child Prot.  
Switch 3m Cord  
Color ○ ●



**WLTB0633-2** □□

3x Socket 2P+E, Child Prot.  
3m Cord  
Color ○ ●



**WLTB0643-2** □□

4x Socket 2P+E, Child Prot.  
3m Cord  
Color ○ ●



**WLTA0455-2** □□

5x Socket 2P+E, Child Prot.  
Switch 5m Cord  
Color ○ ●



**WLTA0465-2** □□

6x Socket 2P+E, Child Prot.  
Switch 5m Cord  
Color ○ ●



**WLTB0635-2** □□

3x Socket 2P+E, Child Prot.  
5m Cord  
Color ○ ●



**WLTB0645-2** □□

4x Socket 2P Child Prot.  
5m Cord  
Color ○ ●



Group Sockets with Earthing (French)

Group Sockets with Earthing (French) and Switch

**WLTB0650-2**□□  
 5x Socket 2P+E, Child Prot.  
 w/o Cord  
 Color ○ ●



**WLTB0660-2**□□  
 6x Socket 2P+E, Child Prot.  
 w/o Cord  
 Color ○ ●



**WLTA0630-2**□□  
 3x Socket 2P+E, Child Prot.  
 Switch w/o Cord  
 Color ○ ●



**WLTA0660-2**□□  
 6x Socket 2P+E, Child Prot.  
 Switch  
 Color ○ ●



**WLTB0651-2**□□  
 5x Socket 2P+E, Child Prot.  
 1,5m Cord  
 Color ○ ●



**WLTB0661-2**□□  
 6x Socket 2P+E, Child Prot.  
 1,5m Cord  
 Color ○ ●



**WLTA0631-2**□□  
 3x Socket 2P+E, Child Prot.  
 Switch 1,5m Cord  
 Color ○ ●



**WLTA6461-2**□□  
 6x Socket 2P+E, Child Prot.  
 Switch 1,5m Cord  
 Color ○ ●



**WLTB0652-2**□□  
 5x Socket 2P+E, Child Prot.  
 2m Cord  
 Color ○ ●



**WLTB0662-2**□□  
 6x Socket 2P+E, Child Prot.  
 2m Cord  
 Color ○ ●



**WLTA0632-2**□□  
 3x Socket 2P+E, Child Prot.  
 Switch 2m Cord  
 Color ○ ●



**WLTA6462-2**□□  
 6x Socket 2P+E, Child Prot.  
 Switch 2m Cord  
 Color ○ ●



**WLTB0653-2**□□  
 5x Socket 2P, Child Prot.  
 3m Cord  
 Color ○ ●



**WLTB0663-2**□□  
 6x Socket 2P+E, Child Prot.  
 3m Cord  
 Color ○ ●



**WLTA0633-2**□□  
 3x Socket 2P+E, Child Prot.  
 Switch 3m Cord  
 Color ○ ●



**WLTA6463-2**□□  
 6x Socket 2P+E, Child Prot.  
 Switch 3m Cord  
 Color ○ ●



**WLTB0655-2**□□  
 5x Socket 2P, Child Prot.  
 5m Cord  
 Color ○ ●



**WLTB0665-2**□□  
 6x Socket 2P+E, Child Prot.  
 5m Cord  
 Color ○ ●



**WLTA0635-2**□□  
 3x Socket 2P+E, Child Prot.  
 Switch 5m Cord  
 Color ○ ●



**WLTA0665-2**□□  
 6x Socket 2P+E, Child Prot.  
 Switch 5m Cord  
 Color ○ ●



Variety of Colors

White Black



The last 2 characters in □□ of product numbers show the item color.

○ White — WH  
 ● Black — BL